

## Davco Sanitized® Superfine White Grout

Internal wall only 1-3mm Joints



Superfine White

## Davco Sanitized® Colorgrout Range

Internal and external, wall and floor 1-6mm Joints

#1 White

#2 Black

#3 Gunmetal Grey

#4 Grey

#5 Silver Grey

#6 Blue Mist

#8 Espresso

#18 Vanilla

#21 Antique White

#22 Ivory

#27 Beige

#28 Sandalwood

#29 Taupe

#38 Terracotta

#44 Dark Brown

#48 Butterscotch

#49 Light Grey

#54 Eucalyptus

#63 Buff

#64 Mocha

## Davco Slate & Quarry Grout Range

Internal and external, wall and floor 6-12mm Joints

Off White

Light Grey

Ivory

Caramel

Sandblast

Neutral

Terracotta

Charcoal Grey

## Davco Sanitized® Colorcaulk Range

White

Grey

Vanilla

Ivory

Light Grey

## Davco Davsil Range

White

Grey

Vanilla

Antique White

Ivory

Beige

Light Grey

Colours shown are a guide only. ParexDavco takes every possible precaution to ensure accurate colour reproduction and consistency, however actual colour shade may vary due to factors beyond our control.

# HOW TO GROUT

## General

- Grouting should be carried out in accordance with AS3958.1 "Guide to the Installation of Ceramic Tiles".

## Preparation

- Ensure the tile adhesive has set firmly before commencing grouting - Refer to adhesive packaging for time required.
- Remove all spacer lugs.
- Ensure all joints are clean and dry before commencing.
- Scrape out any adhesive material which has risen up into the joint between adjacent tiles.
- Be sure to allow for movement / expansion joints, free of adhesive and grout. Fill these joints with Davco Davsil.

## Mixing

- Always use a clean bucket and clean water.
- Always use correct mix ratio - See table - Never re-mix with more water; this will produce weak grout.
- Only mix enough grout as can be used within the pot life of the product – See product packaging for pot life. Note that pot life is reduced at temperatures above 20°C.
- Discard any grout which stiffens before use.
  1. Measure the correct quantity of water into the bucket.



### Quantity of Water Required for mixing (L)

Quantity Grout (kg)	Davco Sanitized® superfine White Grout	Davco Sanitized® ColourGrout	Davco Slate & Quarry Grout
1.5	0.37-0.40	0.30-0.35	-
5	1.25-1.35	1.00-1.15	0.75-0.90
10	2.50-2.70	-	1.50-1.75
15	-	3.00-3.45	-
20	5.50-6.00	-	3.00-3.50

2. Slowly add the grout powder to the water.
3. Stir the mix until it has a lump free, toothpaste consistency.
4. Allow to stand for five minutes. Re-stir and then apply the grout.

## Improved Performance

Use Davco 4-in-1 Grout Additive combined with water for superior performance including flexibility for grouting over timber floors (with fibre cement sheet laid under the tiles) or where movement is expected.

## Application

1. Lightly dampen joints prior to grouting, particularly when using porous tiles or in hot conditions. Do not over-water; joints should be visibly damp but not shiny or wet.

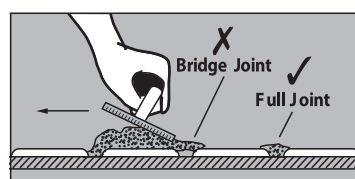

2. Work the grout in a diagonal motion using a rubber float or squeegee.
3. Ensure the grout does not just bridge (sit on top of) the joint.
4. Remove excess grout while still wet with the rubber float in a diagonal motion to avoid dislodging the embedded grout from the joints.

## Easy Clean Up

- Leave grouted tiles for around 20-30 minutes before commencing clean up to allow the grout to gain initial set - As an indication the grout should have changed from a glossy appearance to dull, matte appearance.

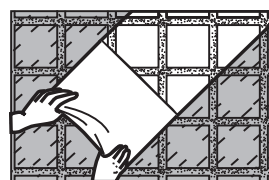

1. Use two buckets of water and two sponges to clean up.
2. Pick up excess grout with the first and clean off with the second. Rinse the sponges regularly in their own buckets of water.
3. Wring out the sponges thoroughly before wiping over the next section to avoid introducing excess moisture back into the grout.
4. After clean up leave the area undisturbed for 24 hours to allow the grout to cure.
5. Wipe over with soft dry cloth to remove grout haze.

# Davco

[www.parexdavco.com.au](http://www.parexdavco.com.au)